

# HS

Conceived with a different philosophical concept, although mixing the technical innovations of the HD series, this brand new HS series offers new and amazing application possibilities leading to believe it has been developed to satisfy after-market operator needs.

As a matter of fact these injectors, due to their reduced size, weight and shape, can be fitted directly on the fuelling tube. The definition of "flying injectors" gives the right idea of this new component, which offers the remarkable possibility of being installed directly on the inlet manifold.

Regarding performance and reliability we are facing a product without compromises, in this case as well, according to the tradition of **MATRIX**.

Mono Fly Version

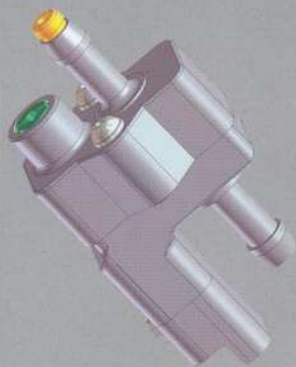

Flow Calibration



Mono Snap-in 90° Version

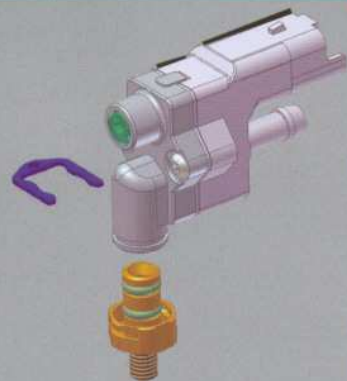

Rail Version

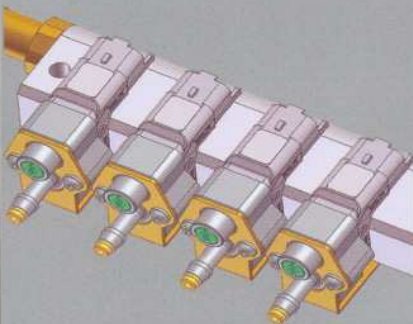

Manifold Version

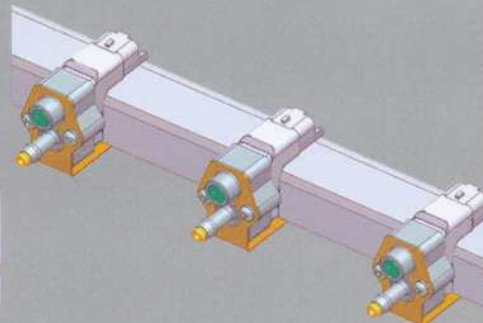

**MATRIX**  
mechatronics

**HS** UNIVERSAL INJECTOR CONCEPT

MATRIX S.p.A.

Corso Vercelli n. 330, 10015 Ivrea (TO) Italy

Tel: +39 0125 615442 - Fax: +39 0125 615377

mail: [matrix@matrix.to.it](mailto:matrix@matrix.to.it) - <http://www.matrix.to.it>